

EZ-Drain Valve

Precision Tool-Free Oil Valves

Part No. 7447

(Includes Cap and Loctite Sealant)

TECHNICAL SPECIFICATION

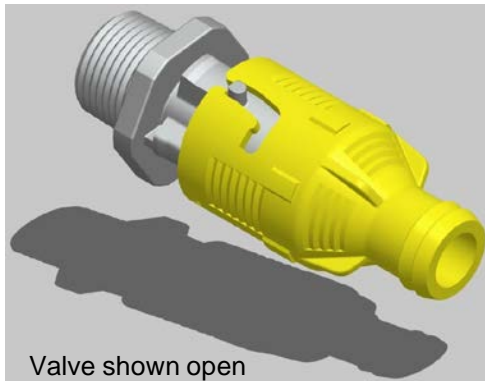

Valve shown open



Valve shown closed with optional cap

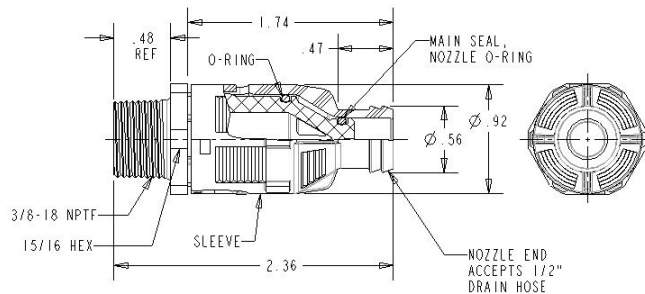

CLOSED POSITION

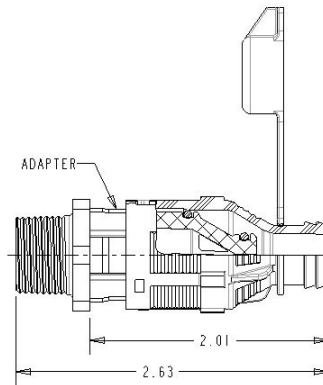

OPEN POSITION WITH
 OPTIONAL CAP SHOWN

Performance Properties	Typical Value
Hole size	3/8-18 N.P.T.F.
Temperature range ⁵	-40°C (-40°F) to 163°C (325°F)
Component materials	Sleeve: Glass Filled PBT Adapter: Zinc Alloy with clear chromate plating O-rings: Nitrile rubber
Time to drain 1 quart of oil ⁶	Approximately 3 minutes
Drain methods	With or without a 1/2 inch I.D. hose

- Optional dry thread sealant, Loctite Vibra Seal #513 (white), available.
- Optional dust cap available. There are 4 part numbers to designate the cap and/or thread seal options, 7446-00-9909 to 7449-00-9909.
- Installation with high speed air drivers possible with a deep well 15/16 hex socket.
- Valve operation: twist and pull to open – push and twist to close.
- Temperature range is for continuous use at ambient temperatures of -40°C(-40°F) to 121°C(250°F) and up to 163°C(325°F) oil temperature.
- Oil was drained from a single cylinder engine that takes 1.5 quarts of oil. The engine was run at normal operating temperatures prior to draining the oil. A 1/2" I.D. hose was utilized for the draining method. Total drain time was until the oil was just dripping from the tube.

This document and its contents contain proprietary information of Fastex Filtration a Division of the Illinois Tool Works Inc. The document and information are to be held in confidence and must not be described, copied or shown, in whole or in part, without the express written permission of ITW Fastex Filtration.