

PROPRIETARY AND CONFIDENTIAL

Description

THE INFORMATION CONTAINED IN THIS DRAWING IS THE SOLE PROPERTY OF INDUSTRIAL SPECIALTIES MFG. AND IS MED SPECIALITES. ANY REPRODUCTION IN PART OR AS A WHOLE WITHOUT THE WRITTEN PERMISSION OF INDUSTRIAL SPECIALTIES MFG. AND IS MED SPECIALITES IS PROHIBITED.

3/8" Inch Hose Barb, Non-Valved Panel Mount Hose Barb Thumb-Latch Type Socket Coupling, 1/4" Flow, Natural Acetal Body and Terminations, Stainless Steel Thumb-Latch, External Springs and Pins, Nickel Plated Brass Panel Nut

NAME	DATE
SCW	40AC-S3-06

PART#	REV
40AC-S3-06	1

SHEET 1 OF 3

SCALE 2.5:1

DO NOT SCALE DRAWING



**Industrial Specialties Mfg.**  
IS Med Specialties

# Specifications

Body and Termination Material	Natural Acetal (POM) - FDA and NSF Compliant for Food Contact
Thumb-latch Material	301 Stainless Steel
Thumb-latch Spring Material	304 Stainless Steel
Pin Material	316 Stainless Steel
Pin Spring Material	302 Stainless Steel
Panel Mount Nut	13/16" 11/16"-24UNS Electrodeposited Nickel Plated Brass
Operating Pressure Range	Vacuum to 120 psi (8.3 bar)
Operating Temperature Range	-40° F to 180° F (-40° C to 82° C)
Flow Capacity	1/4" Size
Barb Size	3/8", 9.5mm
Compatibility Statement	<p>It is the sole responsibility of the system designer and user to select products suitable for their specific application requirements and to ensure proper installation, operation, and maintenance of these products.</p> <p>Material compatibility, product ratings and application details should be considered in the selection. Improper selection or use of products described herein can cause personal injury or product damage.</p>

## Panel Mount Dimensions

	PANEL OPENING	MAX PANEL THICKNESS	MIN PANEL THICKNESS
SOCKETS	See Drawing	0.5"	0.05"
PLUGS	0.688	0.3"	0.05"

PANEL NUT HEX SIZE	PANEL NUT THREAD
13/16"	11/16" - 24UNS

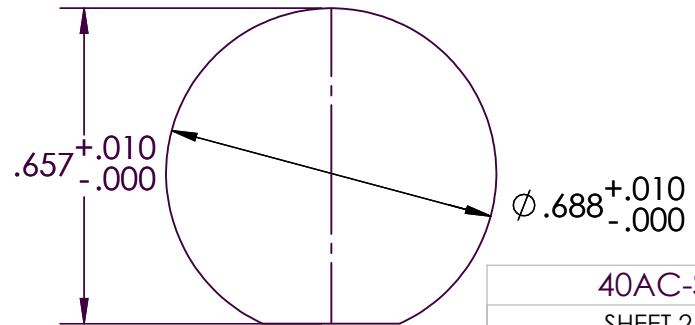

## 40AC Series Air Flow

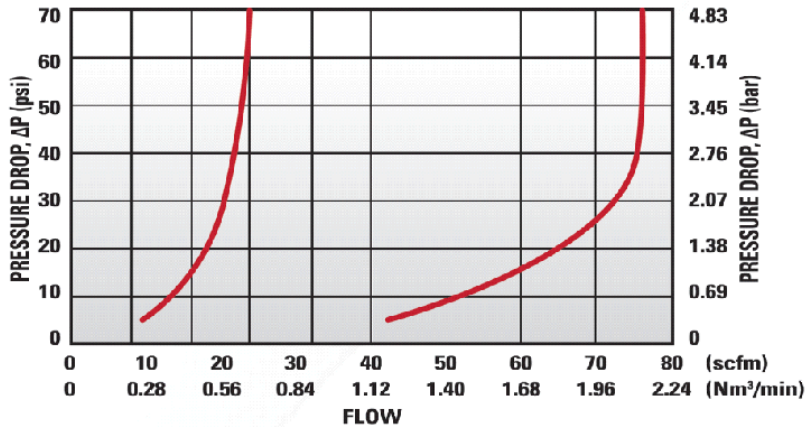

## 40AC Series Water Flow

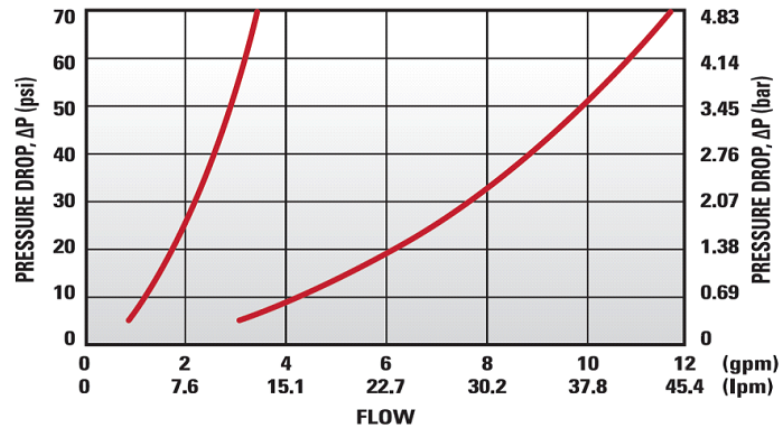

Specific coupling combination flow rates can be determined by using this formula:

$$Q = C_v \times \text{SQRT}(\Delta P / S)$$

SQRT = Square root  
 Q = Flow rate in gallons per minute  
 C<sub>v</sub> = Average flow rate (see chart)  
 ΔP = Pressure drop across coupling (psi)  
 S = Specific gravity of liquid

### C<sub>v</sub> Values for the 40AC-S3-06 Non-Valved Panel Mount Hose Barb Socket Coupling

Plugs:	40ACV-PB2-04	40AC-PB2-04	40ACV-PB2-06	40AC-PB2-06	40ACV-PB9-04	40AC-PB9-04
40AC-S3-06	0.53	0.95	0.80	1.40	0.38	0.39

Plugs:	40ACV-PB9-06	40AC-PB9-06	40ACV-PB1-04	40AC-PB1-04	40ACV-PB1-06	40AC-PB1-06
40AC-S3-0	0.57	1.00	0.70	1.40	0.73	1.40