

SCALE 2 : 1

SCALE 2 : 1

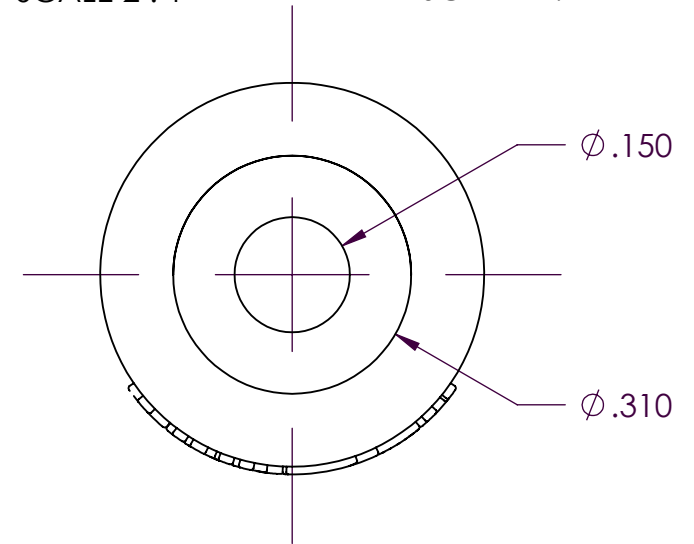
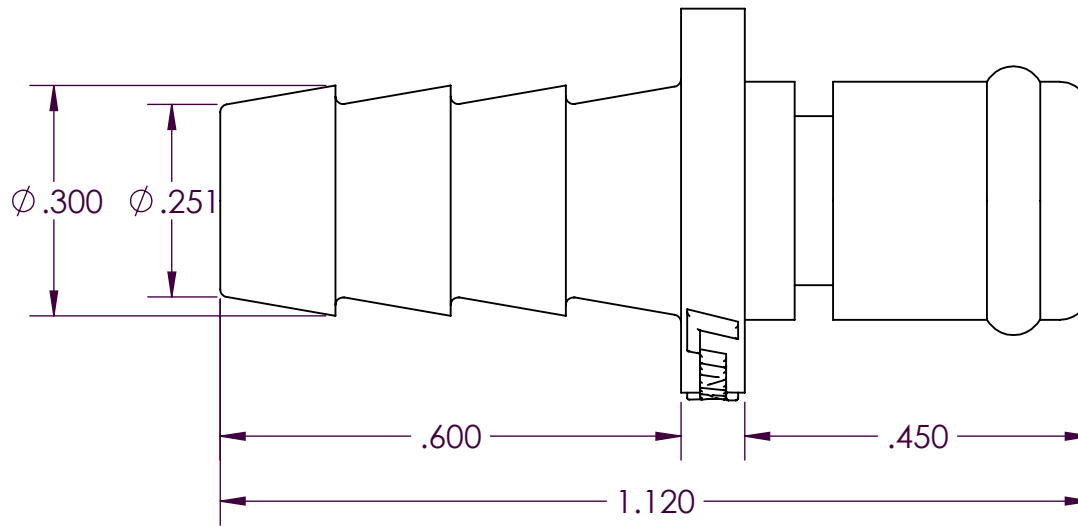

PROPRIETARY AND CONFIDENTIAL

Description

THE INFORMATION CONTAINED IN THIS DRAWING IS THE SOLE PROPERTY OF INDUSTRIAL SPECIALTIES MFG. AND IS MED SPECIALITES. ANY REPRODUCTION IN PART OR AS A WHOLE WITHOUT THE WRITTEN PERMISSION OF INDUSTRIAL SPECIALTIES MFG. AND IS MED SPECIALITES IS PROHIBITED.

1/4" Hose Barb,
Non-Valved In-Line Hose Barb Plug Coupling,
1/8" Flow,
Natural Acetal Body and Terminations,
Buna-N O-ring Seal

NAME	DATE
SCW	07-Nov-14

PART#

20AC-PB2-04

REV
1

SHEET 1 OF 3

SCALE 4:1

DO NOT SCALE DRAWING



Industrial Specialties Mfg.
IS Med Specialties

Specifications

Body and Termination Material	Natural Acetal (POM) - FDA and NSF Compliant for Food Contact
Seal Material Option	Buna-N O-ring - FDA and NSF Compliant for Food Contact O-rings lubricated with Dow Corning 200 food grade silicone oil.
Operating Pressure Range	Vacuum to 120 psi (8.3 bar)
Operating Temperature Range	-40° F to 180° F (-40° C to 82° C)
Flow Capacity	1/8" Size
Barb Size	1/4" ID Tube Size
Compatibility Statement	<p>It is the sole responsibility of the system designer and user to select products suitable for their specific application requirements and to ensure proper installation, operation, and maintenance of these products.</p> <p>Material compatibility, product ratings and application details should be considered in the selection. Improper selection or use of products described herein can cause personal injury or product damage.</p>

20AC Series Air Flow

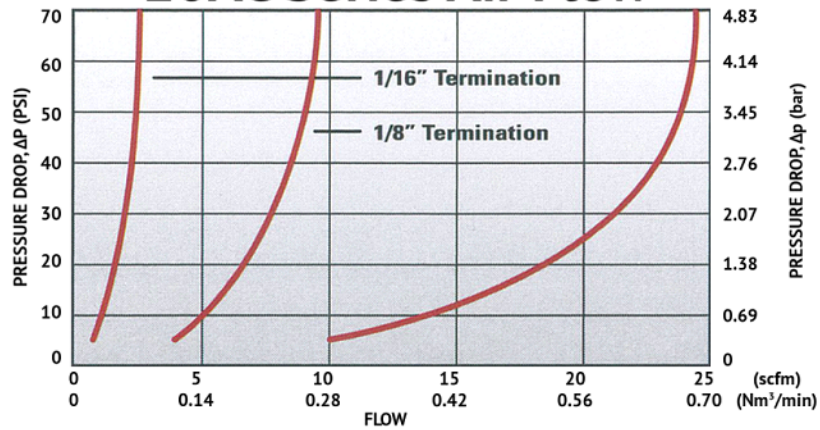

20AC Series Water Flow

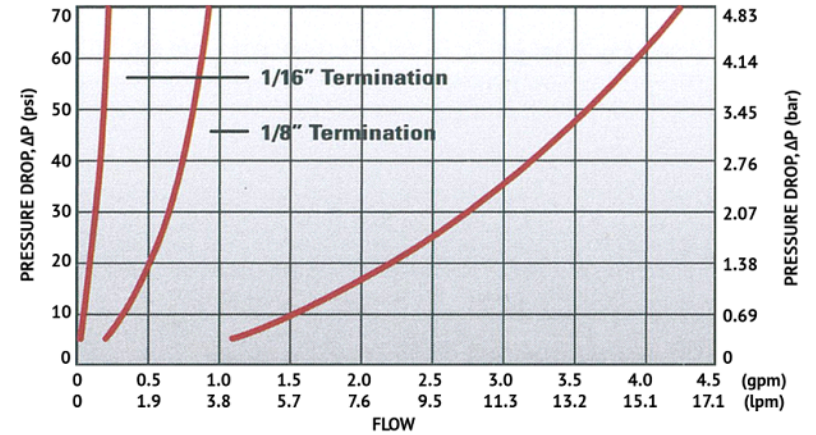

Specific coupling combination flow rates can be determined by using this formula:

$$Q = C_v \times \text{SQRT}(\Delta P/S)$$

SQRT = Square root

Q = Flow rate in gallons per minute

C_v = Average flow rate (see chart)

ΔP = Pressure drop across coupling (psi)

S = Specific gravity of liquid

C_v Values for the 20AC-PB2-04 In-Line Hose Barb Plug Coupling

Sockets:	20ACV-SB2-01	20AC-S2-01	20ACV-SB2-04	20AC-S2-04	20ACV-SB3-02	20AC-S3-02	20ACV-SB3-04
20AC-PB2-04	0.03	0.03	0.26	0.45	0.19	0.27	0.26

Sockets:	20AC-S3-04	20ACV-SB8-04	20AC-S8-04	20ACV-SB1-02	20AC-S1-02	20ACV-SB1-04	20AC-S1-04
20AC-PB2-04	0.45	0.22	0.40	0.28	0.50	0.30	0.50