

BVPM Series – Female NPT 3-Way Ball Valves

September 7, 2018

The bottom port is common and the **BVPM series female NPT 3-way ball valves** can be used as diverter (selecting) valves. Their handle has 180-degree rotation and lies over the open port. When the handle is rotated 90 degrees from either port, flow is shut off to both ports. This valve is panel mountable and has a cast aluminum handle.

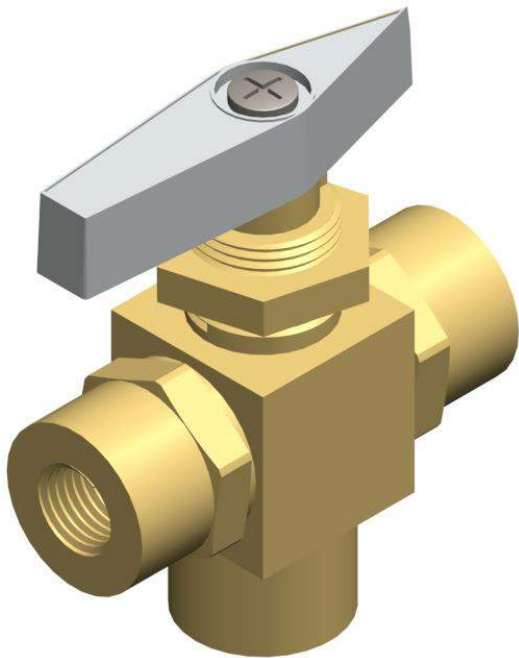

BVPM Series 3-Way Ball Valve Specifications

Operating pressure

29" Hg to 1500 psig WOG, Cold Non-Shock

Operating temperature

10°F (-12.2°C) to 350°F (176.7°C)



FRONT VIEW

Left image

The left port and the bottom or common port are connected while the right port is shut off completely.

Middle image

With the handle rotated 90 degrees, flow is shut off to both ports.

Right image

With the handle rotated 180 degrees, the right port and the bottom or common port are connected while the left port is shut off completely.

BVPM Series Female NPT 3-Way Ball Valve Options

Materials

Body and Ends – Brass
Nickel Plated Brass Ball
Teflon® Ball Seats
Blowout-Proof Brass Stem
Screws – Steel

Seal Options

Double O-Ring Stem Seals (Primary Viton®, Secondary Aflas®)

End Options

1/8", 1/4", 3/8" and 1/2" Female NPT

Handle

Cast Aluminum

Panel Mount

Brass Hex Nut

It is the sole responsibility of the system designer and user to select products suitable for their specific application requirements and to ensure proper installation, operation, and maintenance of these products. Material compatibility, product ratings and application details should be considered in the selection. Improper selection or use of products described herein can cause personal injury or product damage.



Worldwide Suppliers of Pneumatic, Fluidic & Medical Components
ISO 9001:2015 Certified Companies

4091 S. Eliot St., Englewood, CO 80110-4396
Phone 303-781-8486 | Fax 303-761-7939
industrialspec.com | ismedspec.com
© Copyright 2018 Industrial Specialties Mfg.